

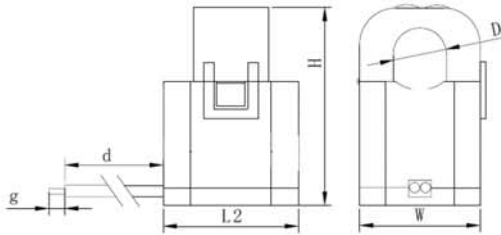

Item	Split Core Current Transformer	Model	E-CT50-SC10
------	--------------------------------	-------	-------------

Dimension(Unit:mm)



Outline Size				Window Size	Leads	
L1	L2	W	H	D	d	g
---	26	23	39	10	1000	6

Electrical Diagram Parameters



Rated Current	50A
Output	333mV
Accuracy	1.0
Frequency	50/60HZ
Insulation Strength	3KV

Performance Curve Specification

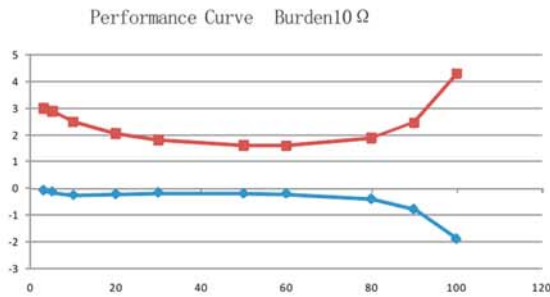

Leads:1015# 24AWG  
Operating Temperature:-20°C to +55°C  
Storage Temperature:-40°C to +70°C  
Features: Split core design, the split core design permits non-contact current measurements through magnetic field induction without requiring that the primary wire be taken offline and disconnected for CT installation. This method permits a safer, easy and portable current measurement.