

Medium Enterprise Environment Monitoring System

ENVIROMUX®

SNMP and Web Monitoring/Management of Critical IT and A/V Operations

Environment Monitoring

- Remote Temperature/ Humidity Sensors over IP
- Temperature
- Humidity
- Water/Chemical Leaks
- Weather
- Power
- Motion / Intrusion / Vibration
- Smoke / Gas
- Live Video & More

Alert Notifications

- Email
- SNMP
- Siren or Alarm Beacon
- Webpage
- Voice Phone Calls
- SMS Messages
- Front Panel LEDs

Key Features

- Supports NTI's advanced sensors which can be extended up to 1,000 feet using Cat5/5e/6 cable.
 - Sensors are hot pluggable.
- Monitor (ping) up to 64 IP network devices – alerts are sent if devices are not responding.
- Sensor conditions (events) can be configured to trigger alerts by themselves, and/or be used in combination with other events to trigger Smart Alerts.
- Integrates with various Open Source monitoring packages – Nagios and MRTG.
 - The unit can be polled via SNMP.
- Optional internal battery backup – alerts are sent when there is a power outage and when power returns.
- USB ports for connecting USB modem or for downloading log data to USB flash drive.
- Supports IP network video cameras for live view of any facility.
 - Any programmed event can trigger a snapshot from an IP camera.
- Cascade up to 5 units via Ethernet connection (1 master, 4 slaves) to increase the number of sensors connected
- Available with dual redundant power for connection to two separate power sources. (The second power supply is sold separately.)
- Optional industrial medium environment monitoring systems for harsh environments with low/high temperatures from -40 to 185°F (-40 to 85°C).
 - Industrial model with backup battery: 32 to 140°F (0 to 60°C)
- Optional intuitive graphical management software provides an easy-to-use, unified interface for both monitoring and configuring up to 3,000 E-2D/5D/16D, E-SEMS-16(U), IPDU-S4/8 units and all connected sensors.
- Available with optional 48VDC power
- Multi-language support – English, German, Chinese, and Japanese.
- Linux inside.



E-5D

- **5 external configurable sensors, 5 digital inputs, 2 output relays**
- **Configure Smart Alerts for different event combinations**
- **Linux inside**
- **User-programmable IP camera snapshots**
- **Cascade up to 5 units via Ethernet connection (1 master, 4 slaves)**

The ENVIROMUX® Medium Enterprise Environment Monitoring System monitors critical environmental conditions, such as temperature, humidity, liquid water presence, power, intrusion, and smoke. When a sensor goes out of range of a configurable threshold, the system will notify you via email, LEDs, alarm beacon, siren, web page, network management (SNMP), voice phone calls (via Automatic Voice Dialer System), and SMS messages (via USB 3G modem).

The system includes two internal sensors: temperature and humidity. It also supports five external configurable sensors, five digital input sensors, and two output relays for control of external devices.

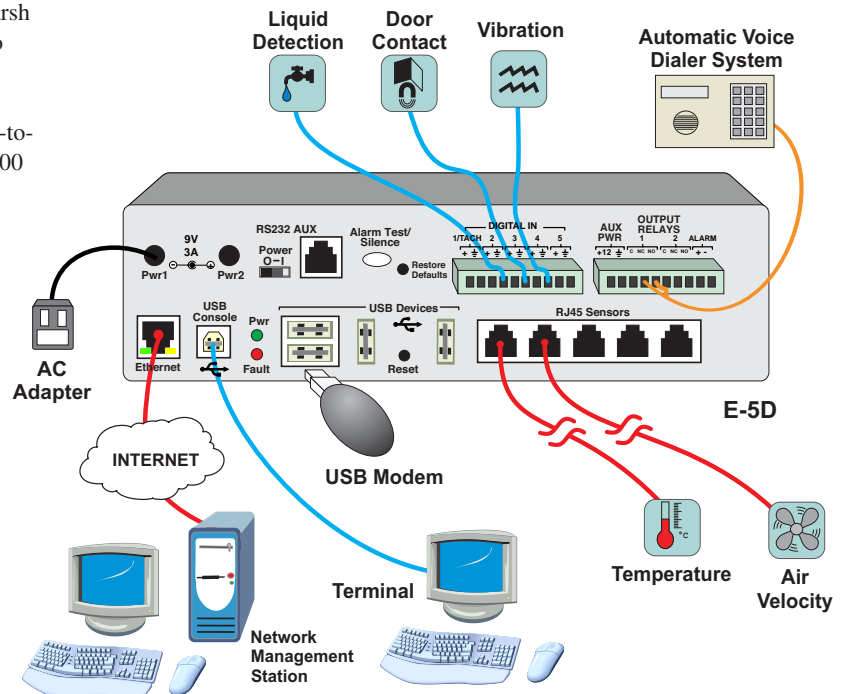

Medium Enterprise Environment Monitoring System

ENVIROMUX®

SNMP and Web Monitoring/Management of Critical IT and A/V Operations

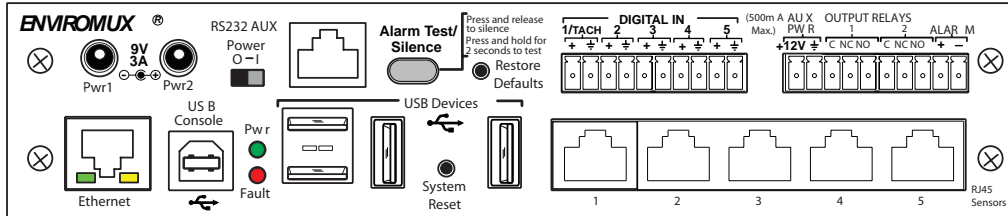

		E-5D
Internal Sensors		2
Temperature		E-5D: 32 to 140°F (0 to 60°C)
		E-5DB: 32 to 104°F (0 to 40°C)
		E-5DB-IND: 32 to 140°F (0 to 60°C)
		E-5D-INDLT/IND48VLT: -40 to 185°F (-40 to 85°C)
Humidity		Applications from 20 to 80% at temperatures between 32 to 140°F (0 to 60°C) for the E-5D, 32 to 104°F (0 to 40°C) for the E-5DB, 32 to 140°F (0 to 60°C) for the E-5DB-IND.
		Applications from 15 to 90% at temperatures between 40 to 185°F (-40 to 85°C) for the E-5D-INDLT/IND48VLT
RJ45 Sensor Ports		5 - Provides +12 VDC, 100 mA for each port
Digital Inputs – Screw Terminal Pairs		5 - Input voltage: 0VDC to +25VDC
Output Relays – Screw Terminal Pairs		2 (Normally open / normally closed connection points) Maximum switching load: 0.5A at 125VAC, 1A at 30VDC, 0.5A at 48VDC.
Remote Temp/Humidity Sensors over IP		8
Alarm Port – Screw Terminal Pair		1
USB Console Port		One female USB Type B connector for terminal access
RS232 AUX Port		One RJ45 port for connecting a serial GSM modem or a remote serially-controlled device
AUX Port – Screw Terminal Pair		1 (12V)
Ethernet Port		One 10/100 Base-T Ethernet port with RJ45 Ethernet connector
USB Port		4 female USB Type A connectors for connecting USB modem or for downloading log data to USB flash drive
Alerts		7 methods
	Email	Authenticates
	Web Interface	✓
	SNMP network management	V1/V2c/V3
	Front Panel LEDs	LEDs for sensors and power
	SMS Messages	Via external USB 3G modem (not included)
	Voice Phone Calls	Via automatic voice dialer system (not included)
	External Alarm	Via alarm beacon or siren (not included)
Smart Alerts		Up to 50 sensor conditions (events) can be configured to trigger alerts by themselves Up to 20 Smart Alerts can be configured to use different event combinations to send alert messages
Alarm Silence / Test Button		✓
Control Methods		5 methods
	Web Interface	HTTP/HTTPS
	Telnet	✓
	SSH	✓
	Network Operation (SNMP)	V1/V2c/V3
	RS232	✓ (via female USB Type B connector)
Monitor (Ping) IP Devices		Up to 64 devices
Protocols		HTTP/HTTPS, SNMP V1/V2c/V3, SMTP, TCP/IP, Syslog, SNTP, DHCP, SSHv2, SSLv3, TLS v1.2, LDAPv3, XOAUTH2, AES 256-bit, 3DES, Blowfish, RSA, EDH-RSA, Arcfour, IPV6, WAP 2.0, RADIUS
Languages Supported:		English, German, Chinese, Japanese
Flash Upgradeable		✓
Restore Defaults Button		✓
System Reset Button		✓

SNMP and Web Monitoring/Management of Critical IT and A/V Operations

	E-5D
Operating Temperature	E-5D: 32 to 140°F (0 to 60°C)
	E-5DB: 32 to 104°F (0 to 40°C)
	E-5DB-IND: 32 to 140°F (0 to 60°C)
	E-5D-INDLT/IND48VLT: -40 to 185°F (-40 to 85°C)
Power	Dual DC power
	Input: 100 to 240 VAC at 50 or 60 Hz via AC adapter
	Output: 9 VDC, 3A
	Optional 48VDC power.
Expandable/Cascade	Up to 5 units via Ethernet connection (1 master, 4 slaves)
	Up to 3,000 units via optional management software
Dimensions WxDxH (in)	E-5D(-D): 7.88x3x1.75 in (200x76x44 mm)
	E-5DB(-D): 7.88x3x1.75 in (200x76x44 mm)
	E-5D-48V: 10.6x3.1x1.75 in (269x79x44 mm)
	E-5DB-IND: 10.6x3.1x1.75 in (269x79x44 mm)
Mounting	Zero-RU
	Optional DIN mounting
	Optional 1RU rackmount kit (mountable with sensor connectors facing the front or back of the rack)
Regulatory Approvals	CE, RoHS