

# LCD MONITOR ARMS

Save desktop space with ergonomic, articulating LCD arms and mounting brackets

**ARM-WL-LCD-LE\***  
(with Extension)



\* Monitor not included

**ARM-WL-LCD-BR\***



**ARM-WL-LCDKB-L\***



## Features & Applications

The LCD Monitor Arms and Mounting Brackets are designed to allow effortless height, tilt and rotation adjustment of the monitor by hand. Ruggedly constructed from lightweight aluminum alloy, the arms mount easily on a wall allowing the user to save desktop space while providing maximum viewing flexibility.

- Spring-assisted and friction-based design provides quiet and smooth knob-less repositioning.
- Compliant to VESA® 75mm or VESA 100mm Standard mounting hole patterns.
- Locking screws on arms and brackets hold monitor stationary on horizontal and/or vertical axis.
- Compatible with NTI's CRYSTALMON™ LCD monitors

## Specifications

### Wall Mount LCD Arms

- ARM-WL-LCD-L Light Load Wall Mount LCD Arm (see Illustration A on page 2)
  - Load capacity: 10 - 18 lbs.
- ARM-WL-LCD-H Heavy Load Wall Mount LCD Arm (see Illustration A on page 2)
  - Load capacity: 15 - 24 lbs.
- Range of motion:
  - Arm side-to-side rotation: 180°.
  - Arm vertical adjustment: 90°
  - Monitor tilt adjustment: 45° up and 25° down.
  - Monitor side-to-side rotation: 180°.
  - Portrait/landscape rotation: 90°.
- Includes:
  - VESA 75mm LCD pivot head
  - VESA 75mm to VESA 100mm conversion kit
  - 430mm (17 in.) adjustable arm
  - Wall mount bracket (with anchor screws)
  - Color: white
- Options:
  - Extension Arm:
    - ◆ Die-cast 165mm (6.5 in.) swing extension arm.
    - ◆ Extension arm reduces load capacity by 4 lbs.
    - ◆ Add "E" to end of part number to specify this option.
    - ◆ Arms with this option available in white or black
  - ARM-EX-LCD-DL Dual LCD Extension Bar (see Illustration E on page 2):
    - ◆ Dual monitor extension bar supports two LCDs on one bracket
    - ◆ Mounting position of LCD pivot head can be adjusted to fit different size LCDs
    - ◆ Range of motion:
      - Individual monitor side-to-side movement: 2-3/4"
      - Monitor side-to-side rotation: depends on monitor size.
      - Arm side-to-side rotation: 180°

### Wall Mount LCD Arm with Keyboard/Mouse Holder

- ARM-WL-LCDKB-L Wall Mount LCD Arm with Keyboard/Mouse Holder (see Illustration C on page 2)
- Swing out adjustable mouse tray.
  - Mouse tray can be switched for right or left hand users.
- Load capacity: 10 - 18 lbs.
- Range of motion:
  - Arm side-to-side rotation: 180°.
  - Arm vertical adjustment: 90°
  - Monitor tilt adjustment: 45° up and 25° down.
  - Monitor side-to-side rotation: 180°.
  - Portrait/landscape rotation: 90°.
- Includes:
  - VESA 75mm LCD pivot head.
  - VESA 75mm to VESA 100mm conversion kit.
  - Keyboard platform with mouse tray.
  - 380mm (15 in.) adjustable arm.
  - Wall mount bracket (with anchor screws).
  - Color: white

### Wall Mount LCD Bracket

- ARM-WL-LCD-BR Wall Mount LCD Bracket (see Illustration B below)
- Load capacity: up to 24 lbs.
- Range of motion:
  - Monitor side-to-side rotation: 180°.
  - Monitor tilt adjustment: 45° up and 25° down.
  - Portrait/landscape rotation: 90°.
- Includes:
  - VESA 75mm LCD pivot head.
  - VESA 75mm to VESA 100mm conversion kit.
  - Wall mount bracket (with anchor screws).
  - Available colors: white, black

Save desktop space with ergonomic, articulating LCD arms and mounting brackets

## Specifications (Continued)

### Wall Mount Keyboard/Mouse Bracket

- ARM-WL-KB-BR Wall Mount Keyboard/Mouse Bracket (see Illustration D below)
  - Load capacity: up to 10 lbs.
  - Swing out adjustable mouse tray.
    - Mouse tray can be switched for right or left hand users.
  - Spring pressed clamp and rubber cushions tightly hold any keyboard in position.
- Range of motion:
    - Arm side-to-side rotation: 180°.
    - Arm vertical adjustment: 90°.
    - Tray rotation: 360°.
    - Tray tilt adjustment: 15° up and 25° down.
  - Includes:
    - Keyboard platform with mouse tray.
    - Wall mount bracket (with anchor screws).

### Configuration and Cable Illustrations

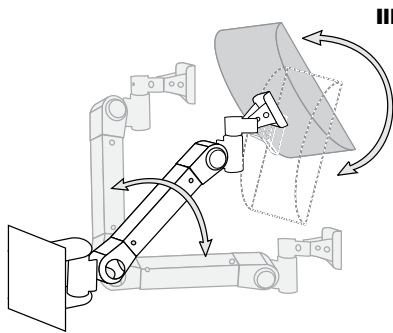

**ARM-WL-LCD-L (Side and Top View)**  
Wall Mount LCD Arm

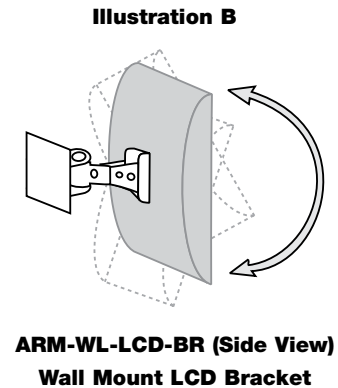
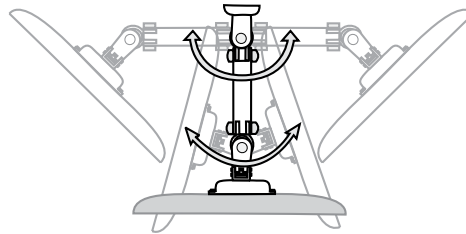

**ARM-WL-LCD-BR (Side View)**  
Wall Mount LCD Bracket

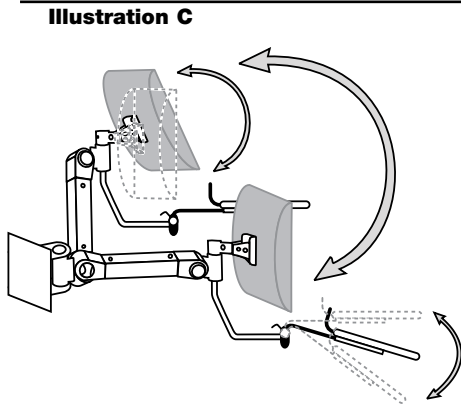

**ARM-WL-LCDKB-L (Side View)**  
Wall Mount LCD Arm with Keyboard/Mouse Holder

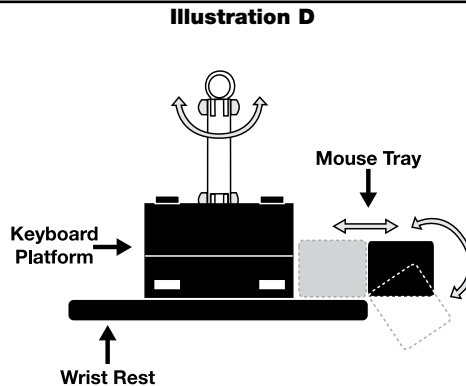

**ARM-WL-KB-BR (Top View)**  
Wall Mount Keyboard/Mouse Bracket

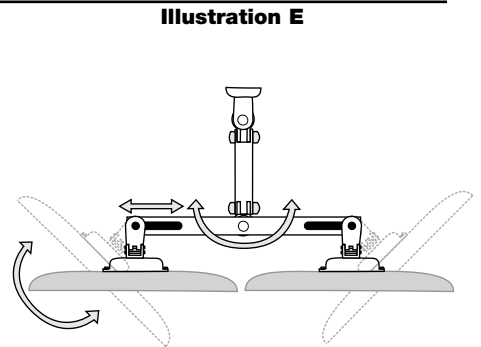

**ARM-EX-LCD-DL (Top View)**  
Dual LCD Extension Bar

### LCD Monitor Arm Models

NTI Part#	Description	Reach (in)	Weight Capacity (lbs)	Color
ARM-WL-LCD-L	Wall Mount LCD Arm	17	10 - 18	White
ARM-WL-LCD-LE	Wall Mount LCD Arm with Extension	23	7 - 15	White
ARM-WL-LCD-LE-K	Wall Mount LCD Arm with Extension	23	7 - 15	Black
ARM-WL-LCD-H	Wall Mount LCD Arm	17	15 - 24	White
ARM-WL-LCD-HE	Wall Mount LCD Arm with Extension	23	11 - 20	White
ARM-WL-LCD-HE-K	Wall Mount LCD Arm with Extension	23	11 - 20	Black
ARM-WL-LCDKB-L	Wall Mount LCD Arm with Keyboard/Mouse Holder	15	10 - 18	White
ARM-EX-LCD-DL	Dual LCD Extension Bar [for use with ARM-WL-LCD-L/H(E)]	NA	NA	White
ARM-WL-LCD-BR	Wall Mount LCD Bracket	4	up to 24	White
ARM-WL-LCD-BR-K	Wall Mount LCD Bracket	4	up to 24	Black
ARM-WL-KB-BR	Wall Mount Keyboard/Mouse Bracket	19	10	White



330.562.1999  
Worldwide fax



sales@ntigo.com



www.networktechinc.com

©2008-2010, NTI  
All rights reserved