

ST-IPUSB4K-LC

HDMI HDBaseT KVM Extender 4Kx2K

User manual



Thank you for purchasing this product. For optimum performance and safety, please read the instructions carefully and keep the manual for future reference.

• **Important safety notice**

Please read below safety instructions carefully before installation and operation:

- * Please pay attention to all the warnings and hints on this device.
- * Do not expose this unit to rain, moisture and liquid.
- * Do not put any stuff into the device.
- * Do not repair or open this device without professional people's guidance.
- * Make sure good ventilation openings to avoid product overheating damage.
- * Shut off power and make sure environment is safe before installation.
- * Do not plug-in/out the connected cables when it is in using.
- * Make sure the specification matched if using 3rd party DC adapters.

• **Introduction**

This HDMI KVM extender consists of a transmitter (TX) and a receiver (RX). The product is network-mediated and uses amplification and extension technology. The transmitter and receiver are extended by a single network cable. The HDMI signal can be extended to 100 meters uncompressed with nearly zero latency by CAT6/CAT6A/CAT7 cable. It supports EDID pass back, supports one-to-many connection through the switch and the resolution supported is up to 4KX2K@30Hz. It supports KVM function, allows access to a computer system from a remote console by USB mouse and keyboard. It is useful for control and security purposes. Therefore it is widely used in command center, data control center, military, bank, government, enterprise etc.

• **Features**

1. Transmitter support one HDMI loop-out
2. HD uncompressed and nearly zero latency transmission

3. Support distance up to 100m via CAT6/6A/7
4. Support one-to-many connection through the switch
5. Support KVM function, remote control conveniently
6. Support EDID pass back
7. Resolution supported is up to 1920x1200 (WUXGA) and 4Kx2K@30Hz
8. Plug and play, easy installation

• Package Contents



Transmitter
(TX)*1pcs



Receiver
(RX)*1pcs

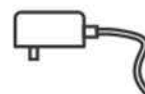

DC5V/1A power
adapter×2

(See last page for more
details on power supply)

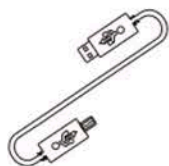

USB Cable x 1pcs



User manual*1pcs

• Installation Requirements

1. Source equipment :
HDMI source device (computer graphics card, DVD, PS3, HD monitoring equipment etc).
2. Display devices:
With HDMI INPUT port, SDTV, HDTV, projector
3. Network cables:
UTP/STP CAT6/CAT6A/CAT7 network cables, which following the standard of IEEE-568B

• Panel Description

1. Transmitter (TX)

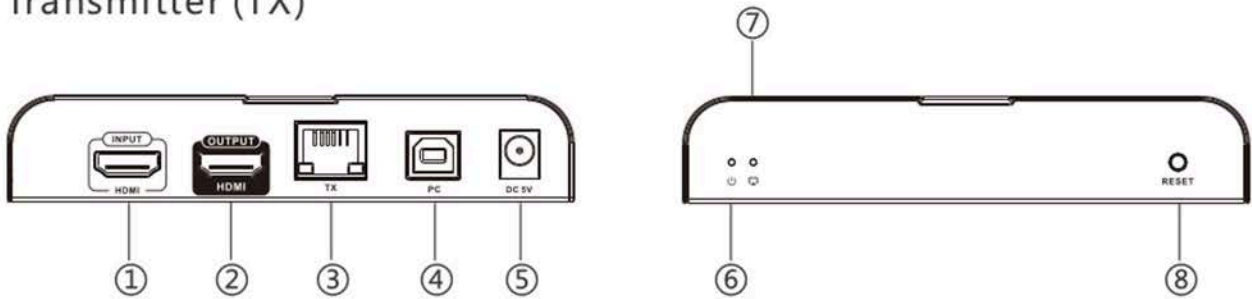

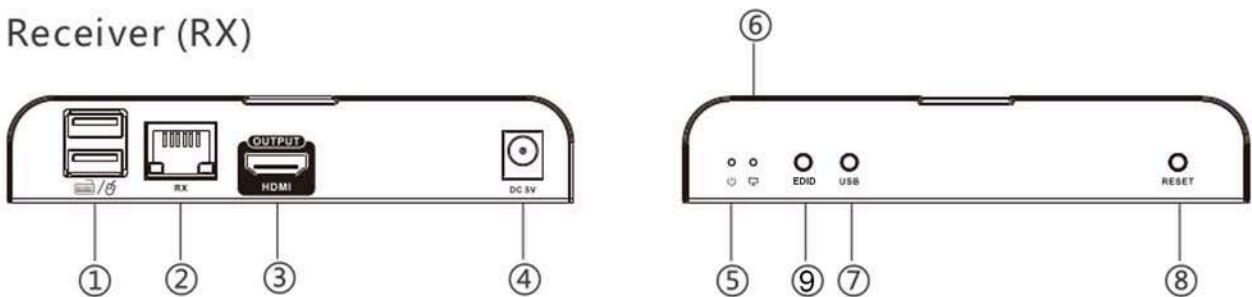

①	HDMI INPUT	Input HDMI signal
②	HDMI OUTPUT	Output HDMI signal
③	TX	Connect with network cable
④	PC	Input USB cable
⑤	DC 5V	Input DC5V power
⑥	⏻	To indicate the power status of the device
⑦	🖥️	To indicate the connection status of the devices
⑧	RESET	Restart the device

2. Receiver (RX)



①	🖱️/⌨️	Connect with mouse/keyboard
②	RX	Connect with network cable
③	HDMI OUTPUT	Output HDMI signal
④	DC 5V	Input DC5V power

⑤		To indicate the power status of the device
⑥		To indicate the connection status of the devices
⑦	USB	Used for switching between multiple receivers
⑧	RESET	Restart the device
⑨	EDID	Press to send EDID from display to transmitter

• Installation Procedures

1. To make a Cat6/6A/7 network cable

Follow the standard of IEEE-568B:



1	white and orange	4	blue	7	white and brown
2	orange	5	white and blue	8	brown
3	white and green	6	green		

2. Connection

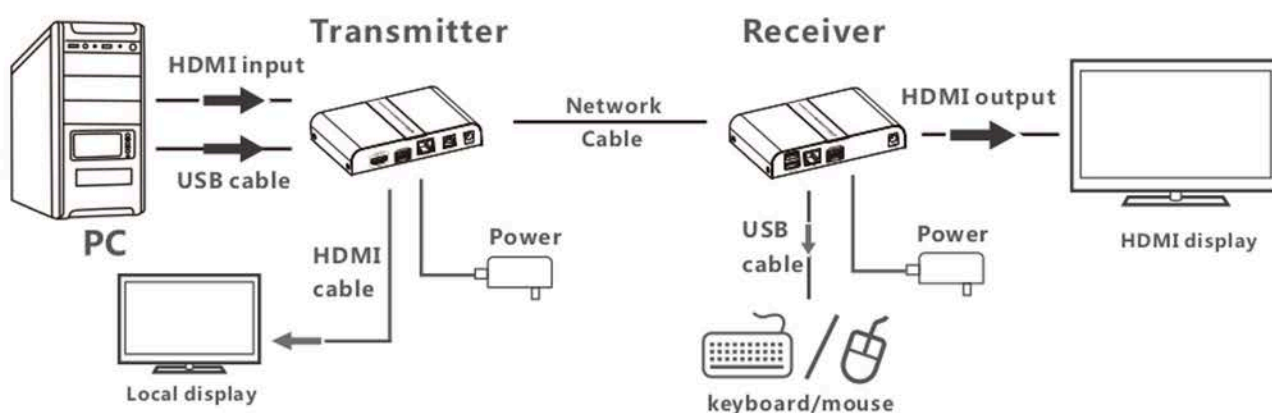

3. Connection instruction

- 1) Connect the PC to HDMI input of the transmitter (TX), If needed to loop out, connect the local display device to the HDMI output of the TX.
- 2) Connect the PC to the USB port of the transmitter (TX).
- 3) Connect HDMI output to HDMI display device.

- 4) Connect the keyboard/mouse to the USB port of the receiver (RX).
- 5) Connect the transmitter and the receiver with the internet cable.
- 6) Plug the power supply into the device to get started.

Note: When using one-to-many connection through the switch, press the "USB" button to switch the receiver to be used. The display connected to the receiver will display the word "USB owner" . The transmitter will automatically match the last receiver.

Note: When using a one-to-one connection, after replacing the display device, if you want to match the EDID of the display device, press the EDID button. The screen will show "Updated EDID". Then press the "USB" button to confirm.

• FAQ

Q: Why does the screen have no output?

- A: 1) Please check and make sure the power supply and all cables are connected well.
- 2) Please check and make sure you have chosen the right HDMI port of all the devices.
 - 3) Please check and make sure there is HDMI signal to be fed into the transmitter and the display is turned on.

Q: Why does the display only have the sound but no synchronous image display?

A: Please set as follows: Right click on the blank space on the desktop- "Screen resolution" (Windows 7) or "Display settings" (Windows 10)- "Multiple displays" - "Extend these displays"

Q: How do I do if the power indicator is on but the connection indicator is off?

- A: 1) Please check the network cable is well-connected to the transmitter and the receiver.
- 2) Restart the transmitter or the receiver.

Q: Why does the keyboard/mouse have no response after connected to the RX?

- A: 1) Please check and make sure the keyboard/mouse is well-connected and electrified.
2) Press the "USB" button of the receiver, check if there is word "USB owner" display on the screen.
3) Restart the receiver.

Q: Why does the output image have the snow point or unstable?

- A: 1) Please change the HDMI cable between the PC and the transmitter, or use a shorter HDMI cable for testing.
2) Please check and make sure the network cable you are using is CAT6/CAT6A/CAT7.

• Specification

Items		Specification
Power supply	Voltage/Current	DC5V/1A
	Power consumption	TX < 3W RX < 2W
HDMI performance and interface	HDMI compliance	HDMI 1.4
	HDCP compliance	HDCP 1.4
	HDMI resolution supported	800x600@60Hz、1024x768@60Hz、1280x720@60Hz、1280x800@60Hz、1280x1024@60Hz、1440x900@60Hz、1680x1050@60Hz、1920x1080@60Hz、1920x1200@60Hz、2560x1080@60Hz、3840x2160@30Hz、4096x2160@30Hz
	Supports audio formats	PCM, LPCM, Dolby, DTS
	Maximum transfer rate	10.2Gbps
	Input and output TMDS signal	0.7~1.2Vp-p(TMDS)
	Input and output DDC signal	5Vp-p(TTL)
	Input cable length supported	≤5m(AWG24)
Output cable length supported	≤5m(AWG24)	
Transmission length	CAT6/6A/7	100m
Protection level	Electrostatic protection of the whole machine	1a Contact discharge level 3 1b Air discharge level 3 Standard: IEC61000-4-2

Operating environment	Working temperature	0 ~ 60°C
	Storage temperature	-40 ~ 70°C
	Humidity (no condensation)	0 ~ 90%
Body properties	Dimension	132.37(L)×89.70(W)×24.90(H)mm
	Material	Iron alloy material+crystal panel
	Processing technology	Sandblasting
	Color	Black
	Weight	TX:320g RX:310g

Power Supply

The ST-IPUSB4K-LC comes with two power supplies, one for the Sender, one for the Receiver. The ST-IPUSB4K-R-LC is a Receiver only and comes with a single power supply. The type of power supply provided depends on the model ordered, which determines the type of plug that will be included to connect to your power source.

Model	Power Cord Plug Supplied
ST-IPUSB4K-LC	US NEMA 1-15P
ST-IPUSB4K-LCEU	Europlug CEE 7/16
ST-IPUSB4K-LCUK	UK BS1363
ST-IPUSB4K-LCAU	AS/NZS 3112
ST-IPUSB4K-LCUNVxx	US NEMA 1-15P with country-specific universal power plug adapter

The ST-IPUSB4K-LCUNVxx will include a universal power plug suitable for the power connections found in the country the power supply was ordered for (xx).

xx	Country	xx	Country
ZA	South Africa	RU	Russia
IT	Italy	IL	Israel
CH	Switzerland	AU	Australia
IN	India	EU	Europe
UK	United Kingdom	DK	Denmark

Disclaimer

The pictures on the user manual are just for reference, and there may be some slight difference with the real products.

We reserve the right to make changes without further notice to a product or system described herein to improve reliability, function or design.