



**NTI** NETWORK  
TECHNOLOGIES  
INCORPORATED

1275 Danner Dr Tel:330-562-7070  
Aurora, OH 44202 Fax:330-562-1999  
www.networktechinc.com

# VOPEX-C6HD-4/8HDBT-230/328

## User Manual

Splitter over HDBase-T/Receiver of HDBase-T



(Front and Rear View of VOPEX-C6HD-8HDBT-328)



Thank you for purchasing this product !

For optimum performance and safety, Please read these Instructions carefully before connecting, Operating or adjusting this product.

Please keep this manual for future reference.

## Basic Function:

---

### **4 PORT** .....Dimension:277x155x27mm

- HDMI splitter 1x4 over HDBase-T, 100m extension for 1080p
- 70m extension for optional
- Full HD 1080p cascade at 3 layers
- Small desk or wall mounting
- HDCP v1.2,3D support
- Super IR control system, IR transport channel can be forward or backward per your installation
- Digital audio format, DTS-HD/Dolby-True-HD/LPCM7.1/AC3/DTS/DSD
- Built-in Lanswitch to distribute Internet to each room (-328 models only)

### **8 PORT** .....Dimension:440x200x44mm

- HDMI splitter 1x8 over HDBase-T, 100m extension for 1080p
- 70m extension for optional
- Full HD 1080p cascade at 3 layers
- 19 inch rack or wall mounting
- HDCP V1.2,3D support
- Super IR control system, IR transport channel can be forward or backward per your installation
- Digital audio format, DTS-HD/Dolby-True-HD/LPCM7.1/AC3/DTS/DSD
- Built-in Lanswitch to distribute Internet to each room (-328 models only)

### **REMOTE UNIT**.....Dimension:110x75x23.5mm

- Receiver for HDBase-T products
- 100m long extension over Single Cat5e/6
- 70m extension for optional
- HDBase-T technology
- IR backward
- Built-in Lanswitch to distribute Internet to each room (-328 models only)
- 3D Support

## Specification:

---

HDMI version	High Speed with 3D
HDCP version	HDCP1.2
Support HDMI resolution	1080P/1080i/720P/576P/576i/480P/480i
Support video color bit	deep color 24bit/36bit
Support audio format	LPCM/Dolby-AC3/DTS7.1/DSD
Input Video signal	5.0Volts P-P
Output cable distance	≤5m
Input cable distance	≤5m
Data transfer speed	6.75Gbps-10.2Gbps
Operating Humidity range	5 to 90%RH (No Condensation)
Operating Temperature range	-15 to +55C° (5 to 131°F)
Power adapter format	Input AC(50Hz.60Hz) 100- 240V
Power Supply	DC 12V(4 PORT )9V(8 PORT )

## Operation:

1. Connect the signal source (such as HD-DVD, PS3, STB) with HDMI input interfaces.
2. Connect the display devices (such as HD-LCD, HD-DLP) with HDMI output interfaces.
3. Connect the EIA/TIA 568B one long CAT5e/6 cable to the sender output socket.
4. Connect the EIA/TIA 568B one long CAT5e/6 cables to the Receiver input socket.
5. Connect LCD with HDMI interface to Receiver output socket.
6. This device is powered by an external power supply optional.

## Application :

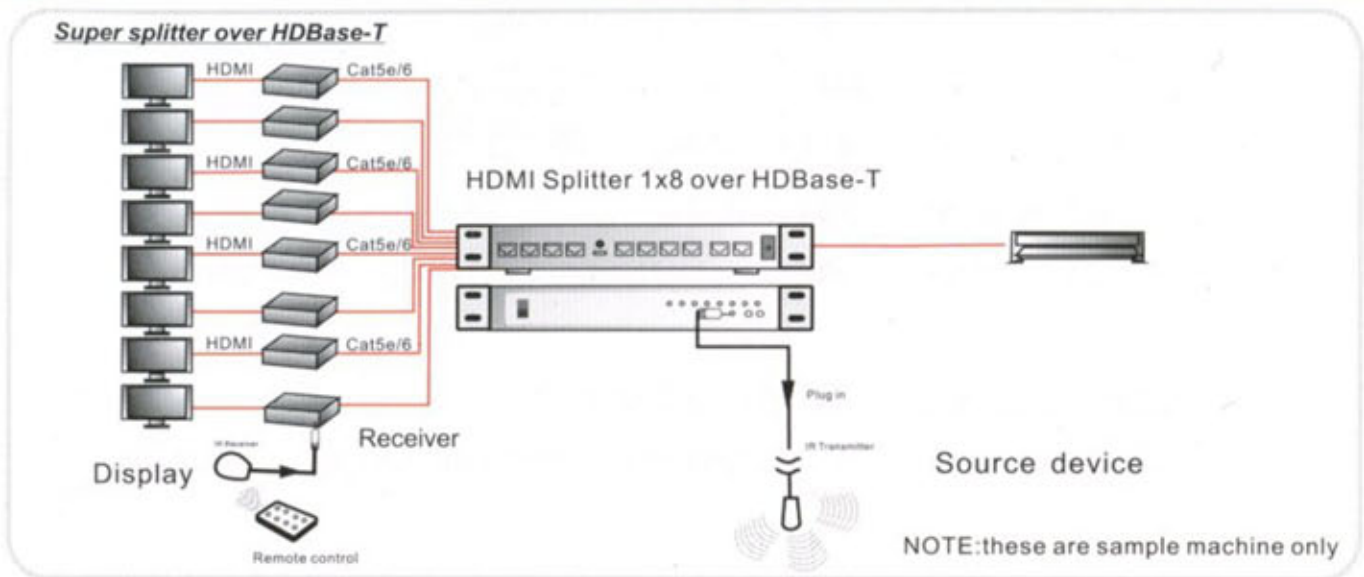

## Package Included:

When first unpacking your HDMI splitter, please check to see if the following items are included:

### 1- HDMI HDBase-T Splitter/Extender

	-4HDBT	-8HDBT
HDBase-T remote units -	4	8
IR transmitter	1	1
IR receivers -	4	8
Main power supply	9V	12V
5V power supplies -	4	8
User manual	1	1

## **Warning:**

---

### **TO REDUCE THE RISK OF FIRE, ELECTRIC SHOCK OR PRODUCT DAMAGE:**

- 1.** Do not expose this apparatus to rain, moisture, dripping or splashing and make sure that no objects filled with liquids, such as vases, are placed on the apparatus.
- 2.** Do not install or place this unit in a bookcase, built-in cabinet or in another confined space. Ensure the unit is well ventilated.
- 3.** To prevent risk of electric shock or fire hazard due to overheating, do not obstruct the unit's ventilation openings with newspapers, tableclothes, curtains and similar items.
- 4.** Do not install near any heat sources such as radiators, heat registers, Stoves or other apparatus.
- 5.** Do not place sources of naked flames, such as lighted candles on the unit.
- 6.** Clean this apparatus only with dry cloth.
- 7.** Unplug this apparatus during lightning storms or when unused for long time.
- 8.** Protect the power cord from being walked on or pinched, particularly at plugs.
- 9.** Only use attachments/accessories specified by the manufacture.
- 10.** Refer all servicing to qualified service personnel.

## New Function:

### ● Backward IR channel optional

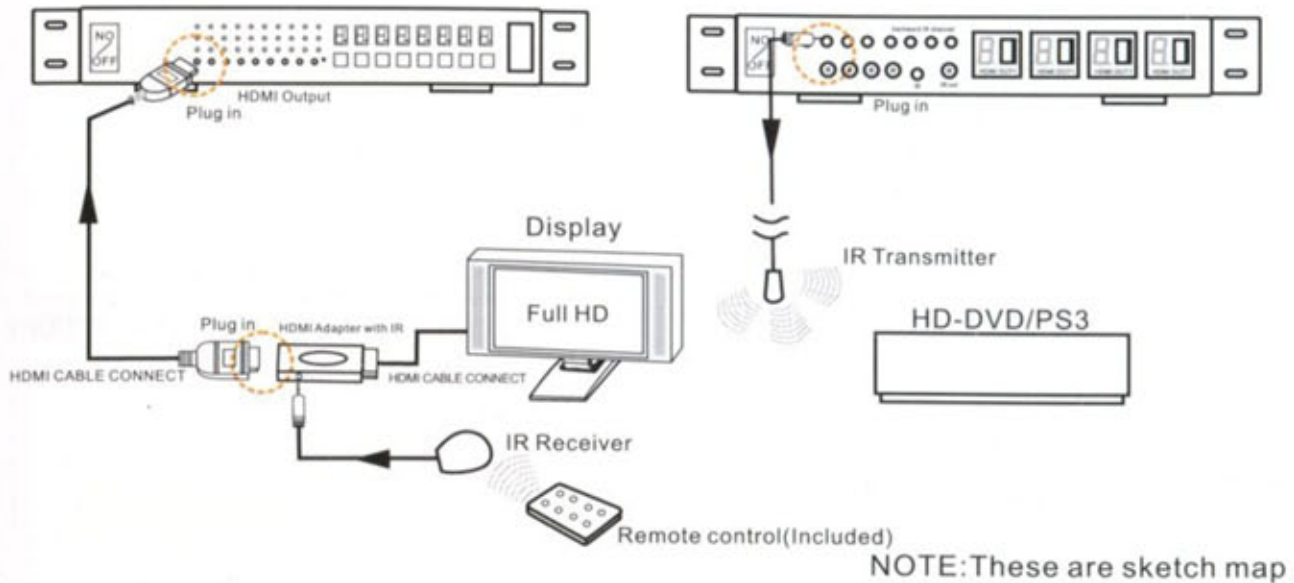

### ● Wall mounting or fixed

① Fix the ear bracket to the machine through 4 screws

NOTE: These are sketch map

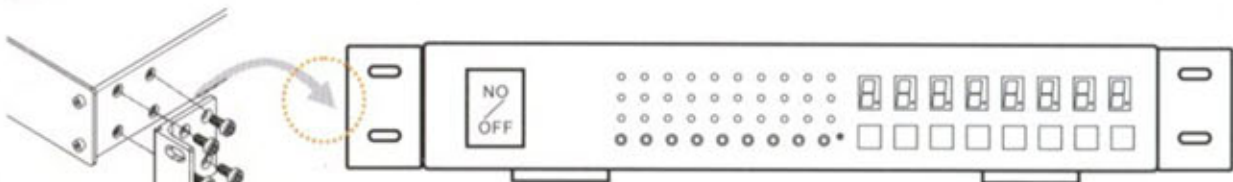

② Place the ears of the machine against the rack rails, and insert the proper screws (not provided) through each of the four holes in the rack ears.

### ● Plug Locking

not easy to loose!

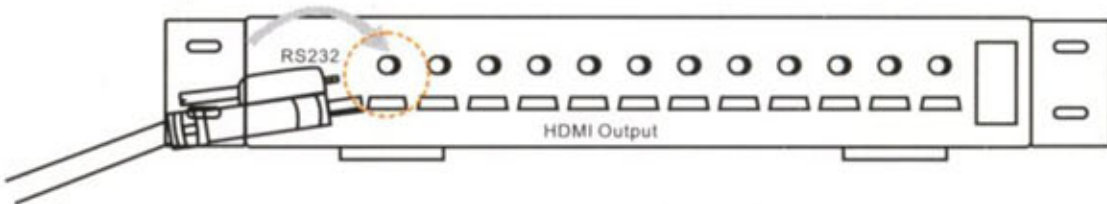

NOTE: These are sketch map

### EXAMPLE OF CASCADED CONFIGURATION WITH VOPEX-C6HD-8HDBT-xxx

